



**KOHINUR**  
INDUSTRIAL COMPLEX



Taloja, Navi Mumbai.



To  
**Experience**  
Perfection



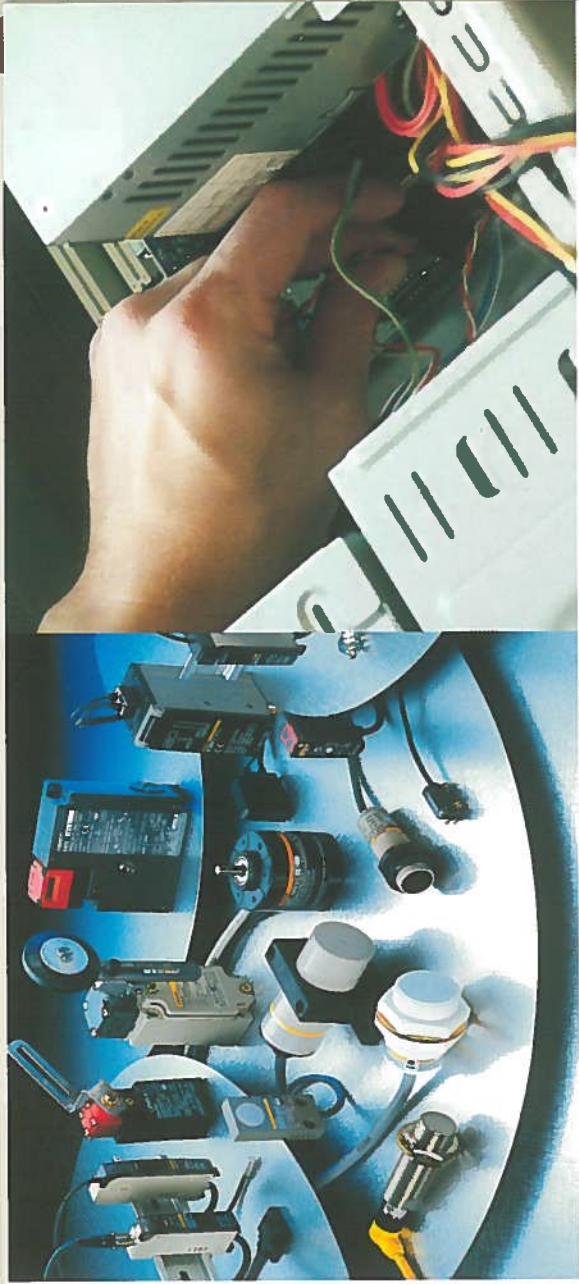

Sometimes big journeys starts from small steps... and great milestones can be achieved with small ideas. India has witnessed many landmarks, built with small ideas and achieved success.

Our Group has started its journey with a small idea & a vision of providing unique and contemporary edifices to the industry. And in a short span of time it has started creating a wave in the real estate arena by achieving new dimensions with innovative thinking and modern day solutions. Today group stands tall for their perfection and uniqueness in every single project. You can envisaged and expect for the best from us in the near future.



To **Enjoy**  
Locality







Taloja poised to become the hub of Navi Mumbai's industrial belt by the virtue of the fact that it has registered tremendous growth and rapid expansion over past few decades. The area admeasuring 900 hectors continues to gain prominence amongst entrepreneurs due to its robust infrastructural capacities, direct accessibility and close proximity to JNPT, newly sanctioned SEZ project and proposed International airport. Hindalco, Deepak Fertilizer and Pidilite Industries Ltd. Are some of the most prominent industrial units in the area.

- Located on old Mumbai Pune Road (Nh4) & Touching Kharghar Node.
- Planned & approved by MIDC
- Superior Educational, Medical & Banking Facilities in proximity.
- 2 Mins. drive to Taloja Railway Station.
- 15 mins. drive to Navi Mumbai International Airport.
- 5 mins. drive from Mumbai - Pune Express Highway.
- Close proximity to JNPT & SEZ



To Realize  
Most Cherished  
Dream



You can envisage setting up your business venture in midst of present-day conveniences and architectural developments; making your every single move easy and productive. Kohinur Industrial Complex is such a place, portraying a picture perfect of class construction and scientific techniques. It's a place where prospects of future are clear and having lot to explore as industrials. In short a brilliant destination to setup business ventures like

- Printing Units
- Automobile Companies
- Packaging Units
- Cutting & Binding Firms
- Garment Factory
- Multiple Engineering Units
- Fabrication Workshops
- Electronic equipments
- Electrical, Mechanical & Engineer Workshops
- Surgical & Pharma equipments
- Multipurpose Working Space
- and others many more ancillary units.

Realize your dream with unique architectural brilliance.

- Architectural piece of sheer brilliance
- G + 3 - structure (Ground floor ht. -15' & 1st. floor ht.-13' )
- R. C. C. frame structure design for light weight green zone industries.
- Kotaha stone flooring for ground floor, 15" x 15" Spartex flooring for 1st. floor and Kadapha Stone flooring for staircase.
- G.I. rolling shutter at both side.
- No Water Logging due to provided ground level height.
- Ample Electrical infrastructure for entire complex.
- Advance fire fighting system.
- 15PH for Gr + 1st Floor interconnected units and 10HP for Ground Floor units , 5HP for First & Second Floor units.
- Each unit has dual excess for emergency exit enabling higher safety and multiple use.
- 3 Tons capacity Goods elevators with 13' wide large lobby space.
- Ample space for loading & unloading vehicular movement area within complex.
- Suitable for small scale Green Zone Industries. (Non Polluted)
- White wash finish on the inside wall and external wall finishing with Snowcern cement paint.
- Common UGT & OHT.













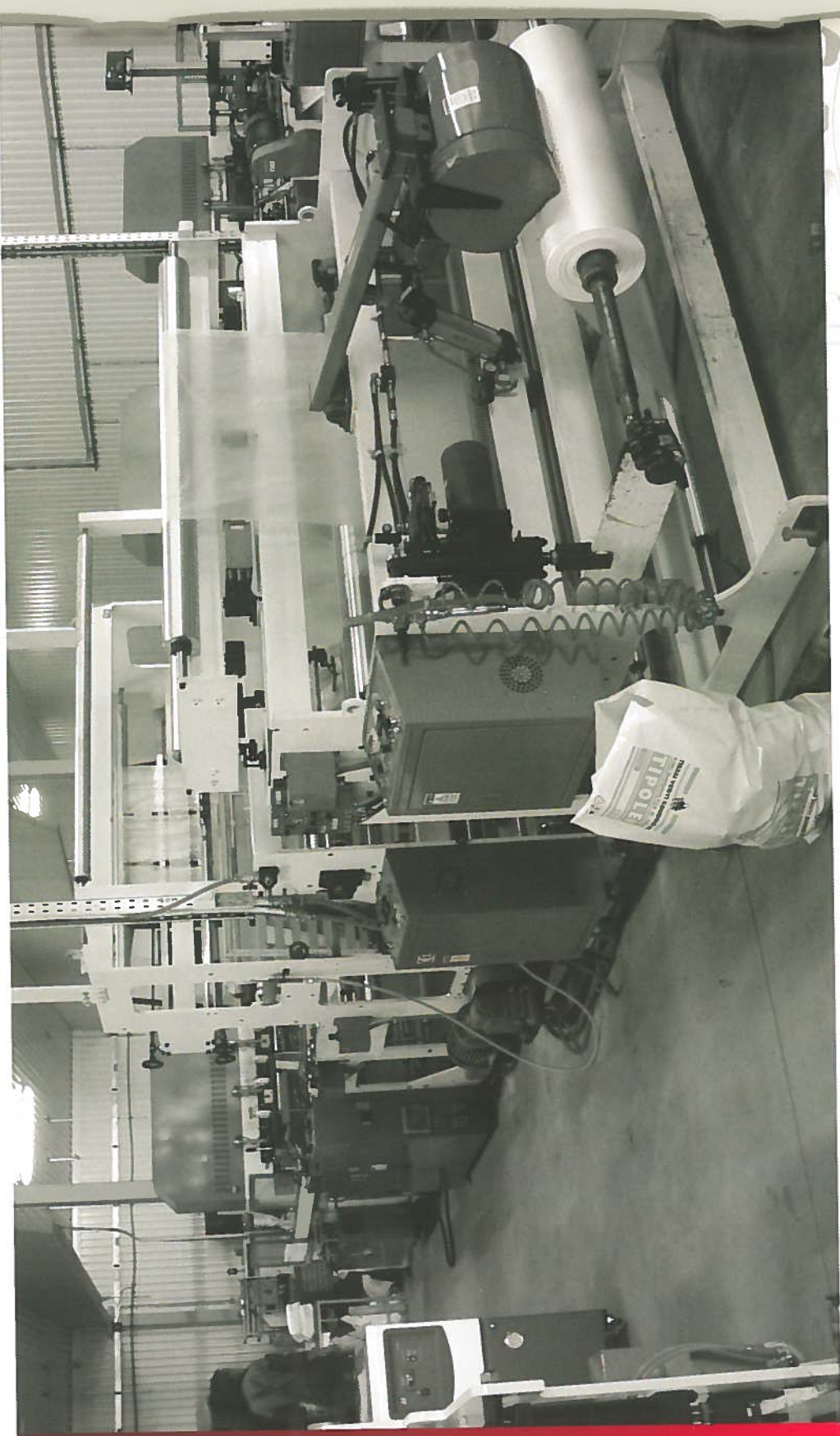

To  
**Reach Business  
Comfort**





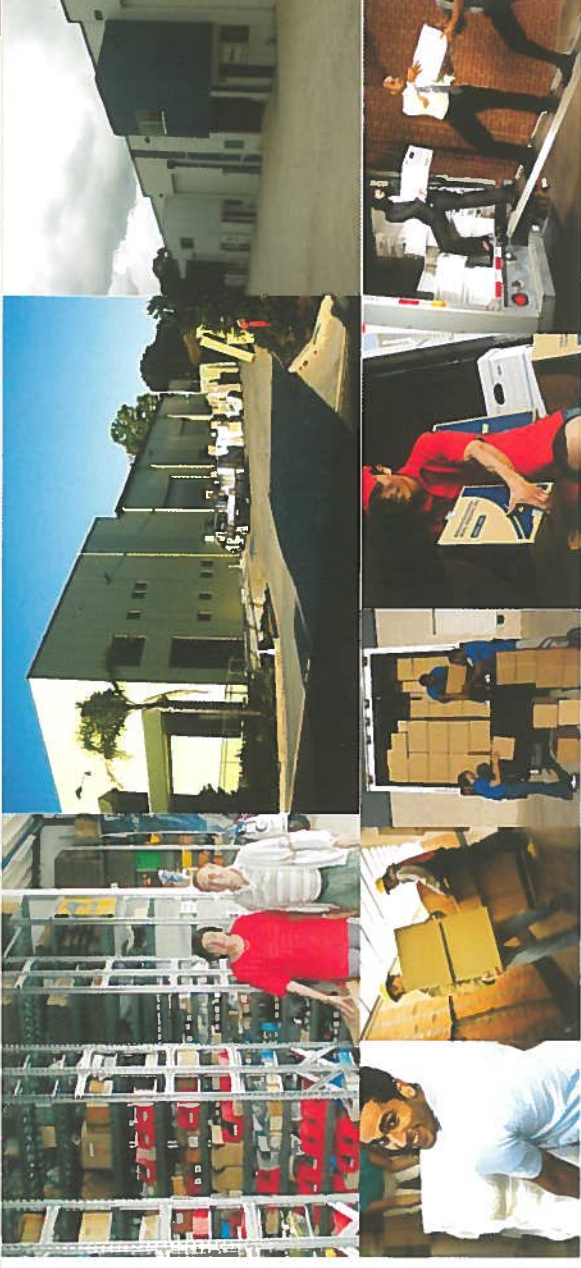

Spectacular designs, soothing ambience and absolute luxuries are there to create a high definition work environment; every single stone at Kohinur Industrial Complex is envisaged and chiselled, keeping business comforts in mind; so that it can help your employees to deliver their best output.

The state-of-the-art architecture of Kohinur Industrial Complex together with the optimum utilization of space sets it apart;

- Good Vehicular Space with ample loading & unloading space
- Required Infrastructure provision for Safety Security & Utilities



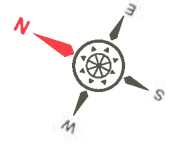

ENTRY/  
EXIT

61 M MAIN ROAD

329" WIDE ROAD

329" WIDE ROAD

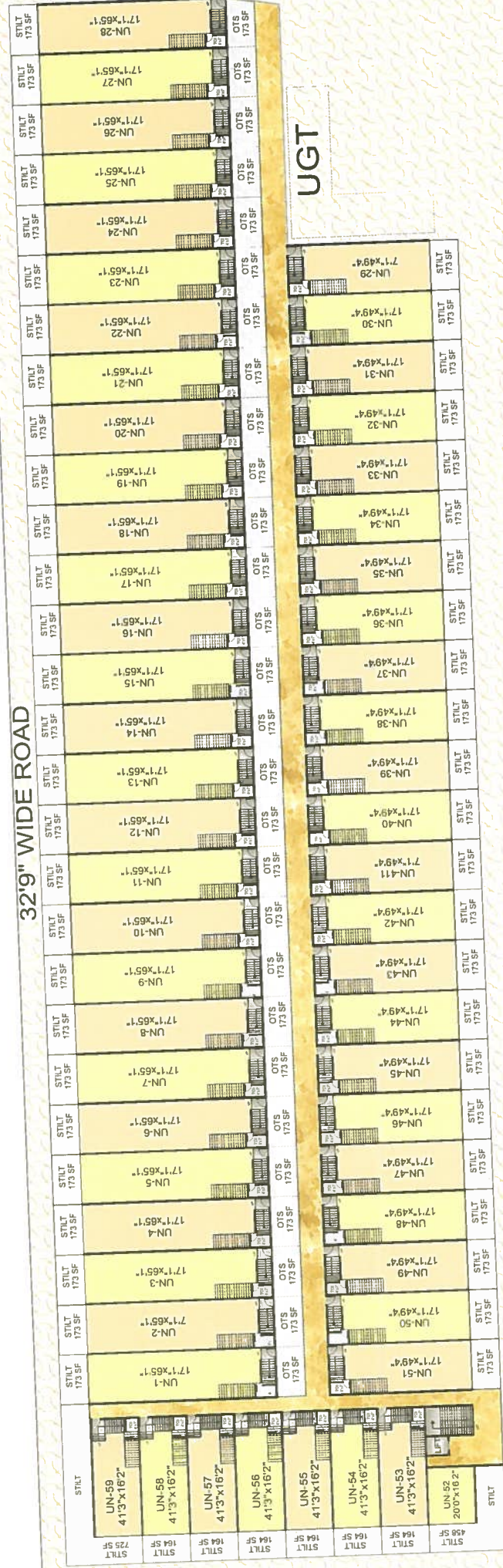

WING-A

296" WIDE ROAD

ENTRY/  
EXIT

25 M WIDE ROAD

72'2" WIDE OPEN SPACE

Electric Substation

PARKING

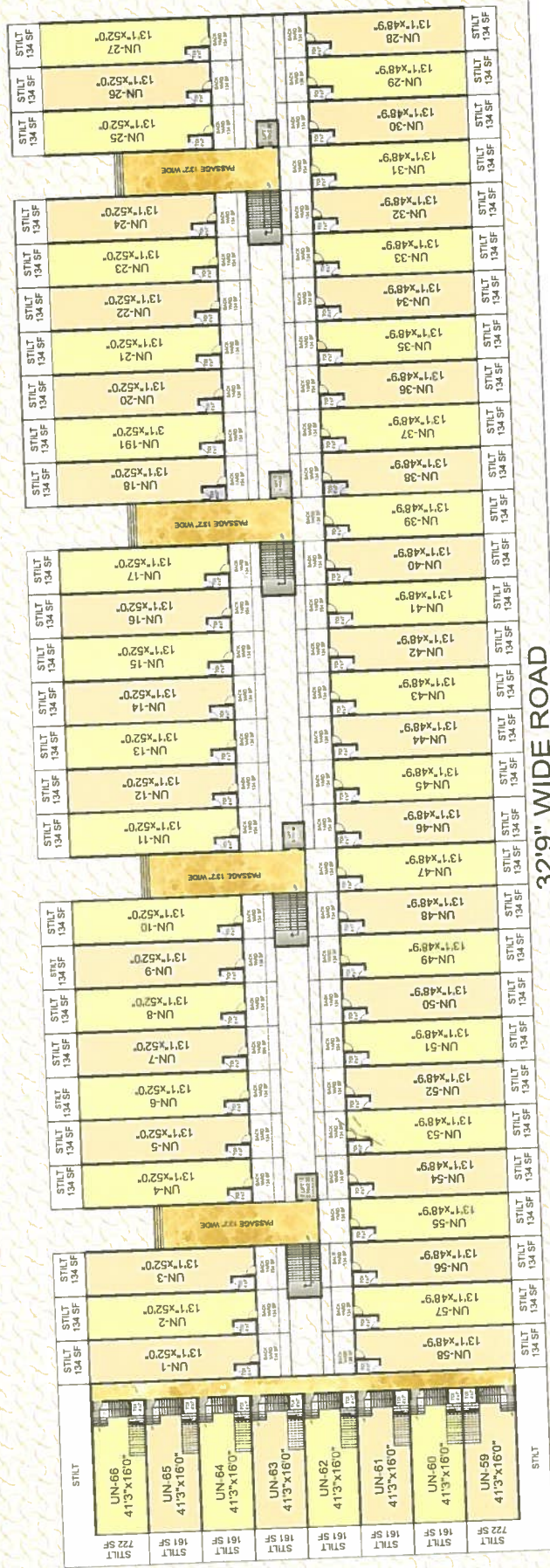

WING-B

296" WIDE ROAD

329" WIDE ROAD

# Ground Floor Plan



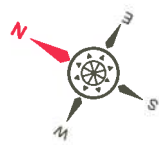

61 M MAIN ROAD

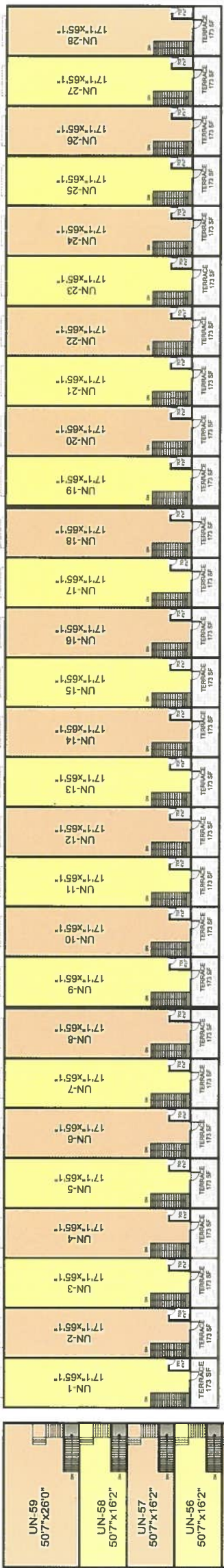

WING-A

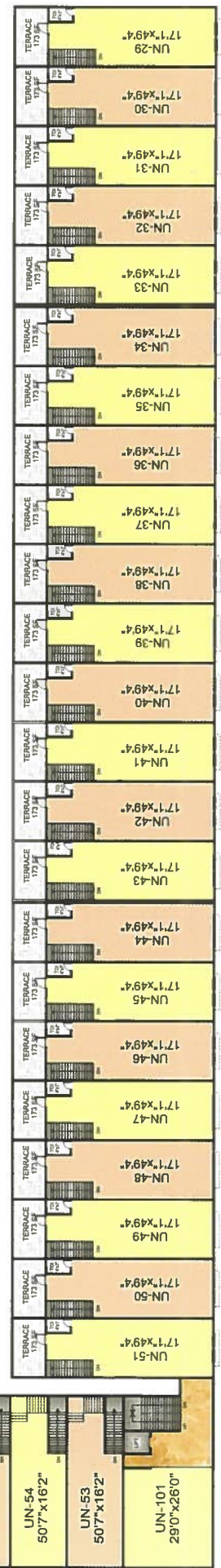

25 M WIDE ROAD

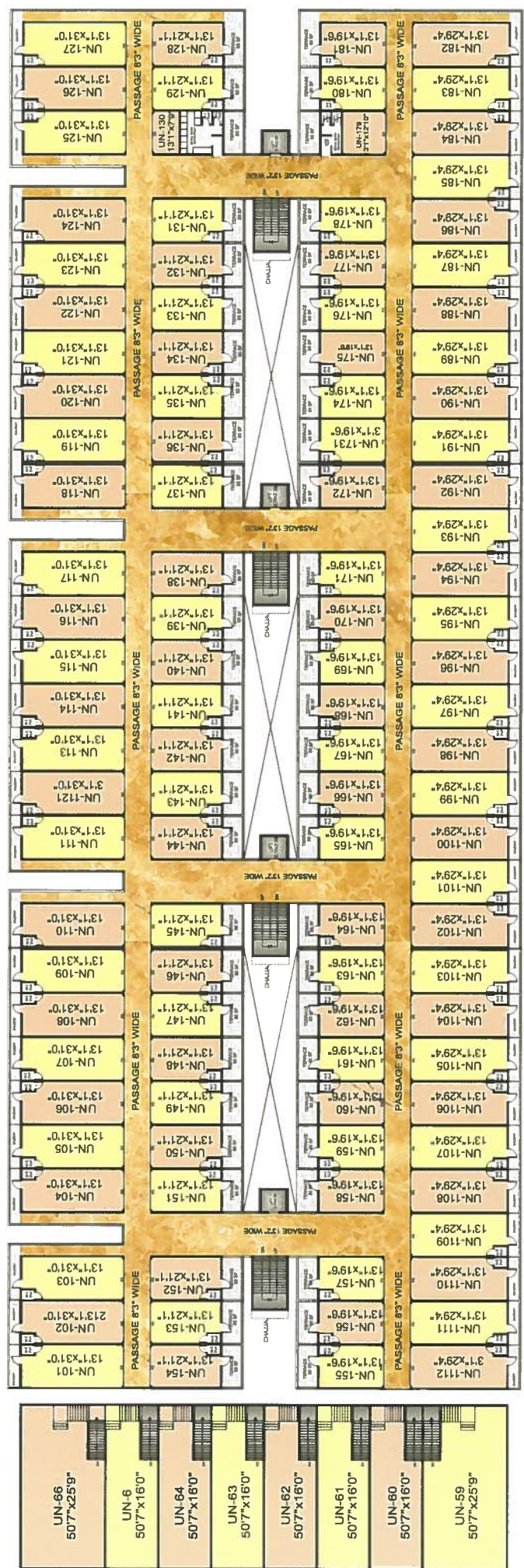

WING-B

First Floor Plan







61 M MAIN ROAD

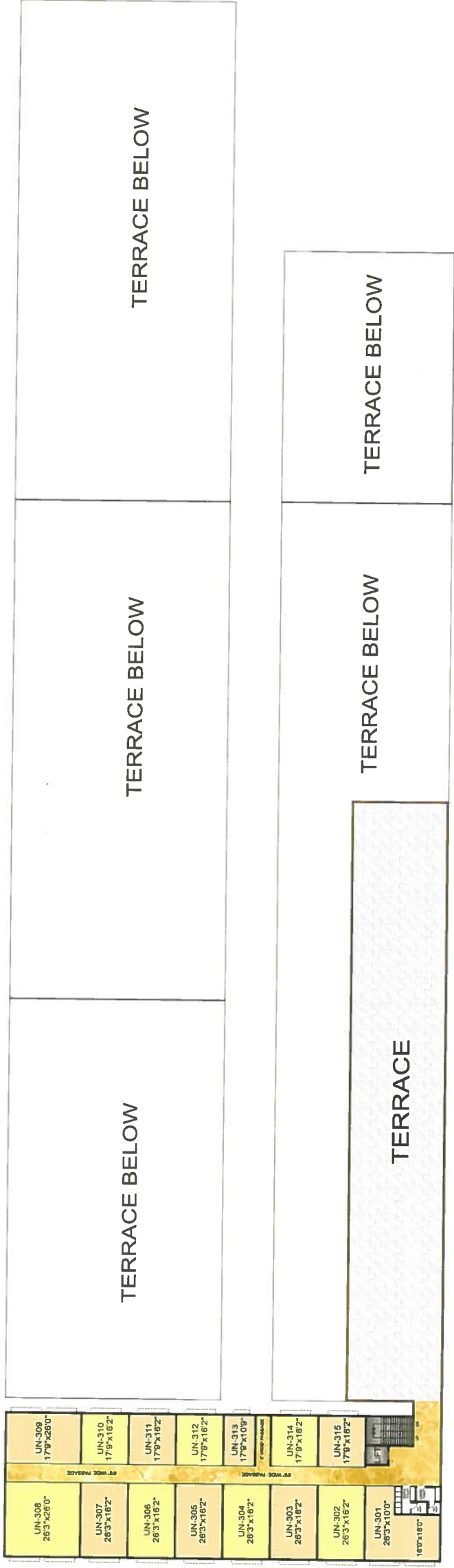

WING-A

25 M WIDE ROAD

72'2" WIDE OPEN SPACE

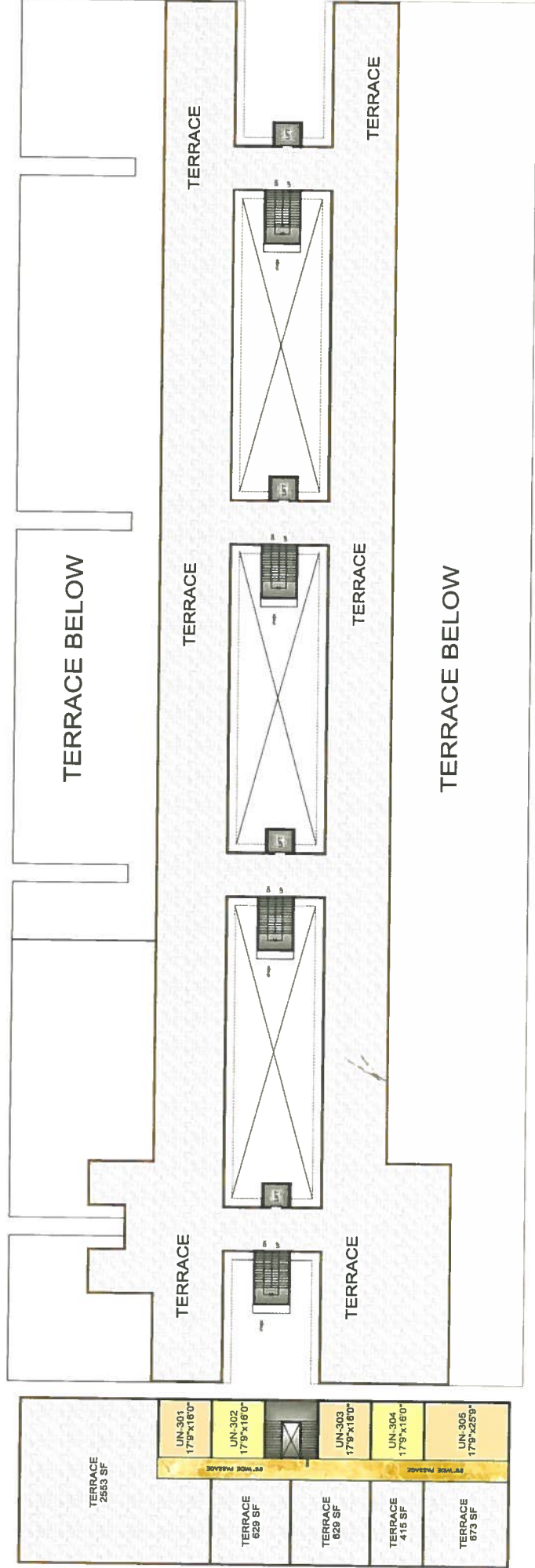

WING-B



Third Floor Plan



# LOCATION MAP

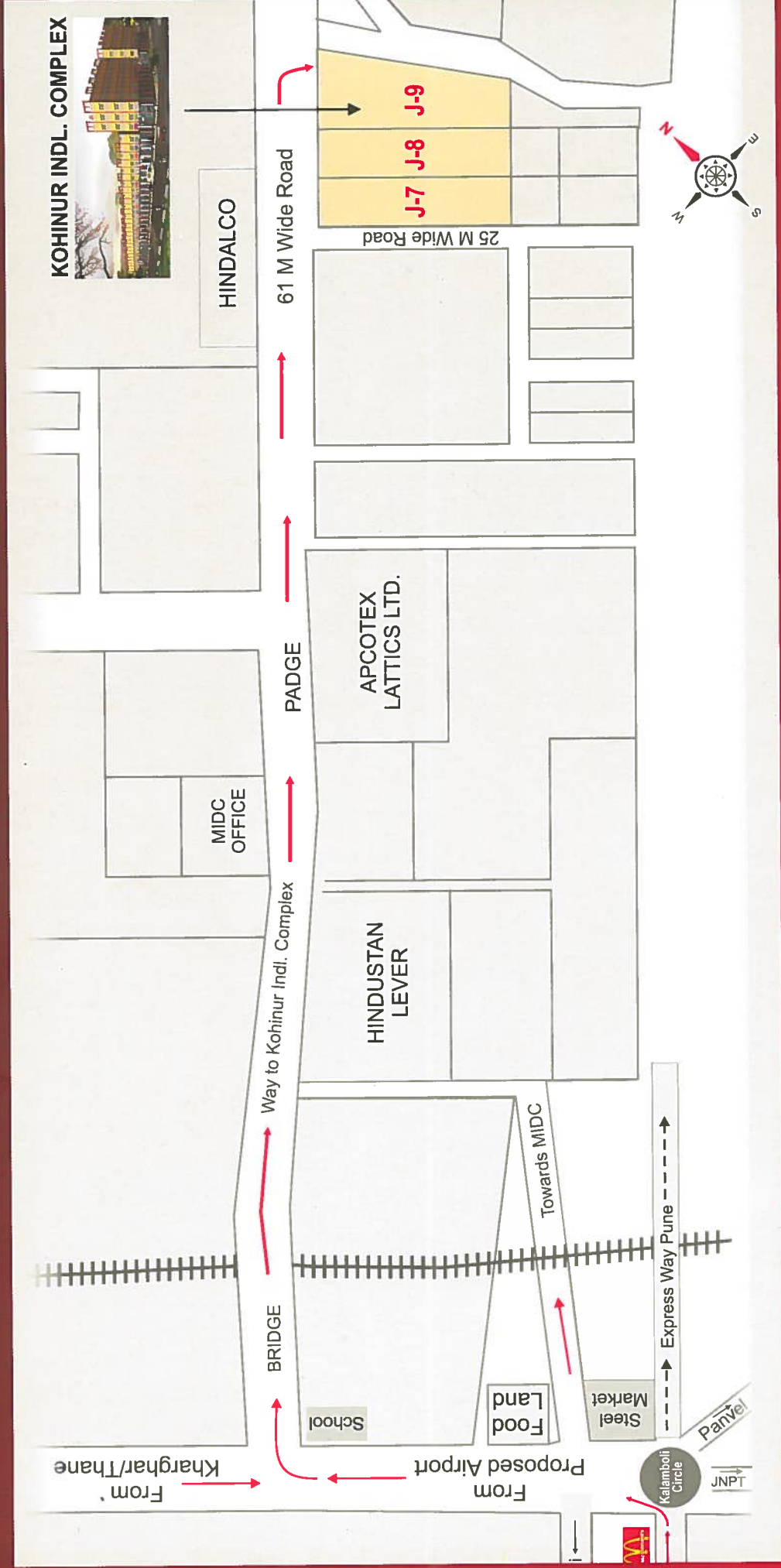

Project by



**DEVKRUPA**<sup>TM</sup>  
**ENTERPRISES**  
 ENGINEERS & BUILDERS  
 DESIGN | DEVELOP | DELIVER

**M/s. M.R. Brothers & Associates Ind. Co. Op. Soc. Ltd.**

Plot No. J7/J8/J9, MIDC, Talaja, Navi Mumbai.

**Contact No. : 93224 89440 / 42 / 36 / 35**

HEAD OFFICE : 4, Devdarshan Complex, Plot No. 23/24, Sec - 19, Kharghar, Navi Mumbai. | Tel.: 022 - 32987069

CORPORATE OFFICE : 811, 812, The Landmark, Plot No. 26A, Sector - 7, Kharghar, Navi Mumbai. | Tel.: 022 - 65141139

www.devkrupaenterprises.in Email : info@devkrupaenterprises.in

ARCHITECT | PATEL & ASSOCIATES      RCC CONSULTANT | S. R. CONSULTANTS

Note: The plans & specifications contained herein is subject to changes as may be approved by concerned authorities and cannot form part of an offer or contract. While every care has been taken in providing this information, the owner / developer / promoter cannot be held responsible for any inaccuracies.





**KOHINUR**  
INDUSTRIAL COMPLEX

Move ahead...



Taloja, Navi Mumbai.